

SMART™ whiteboard frame for the BalanceBox® 400H

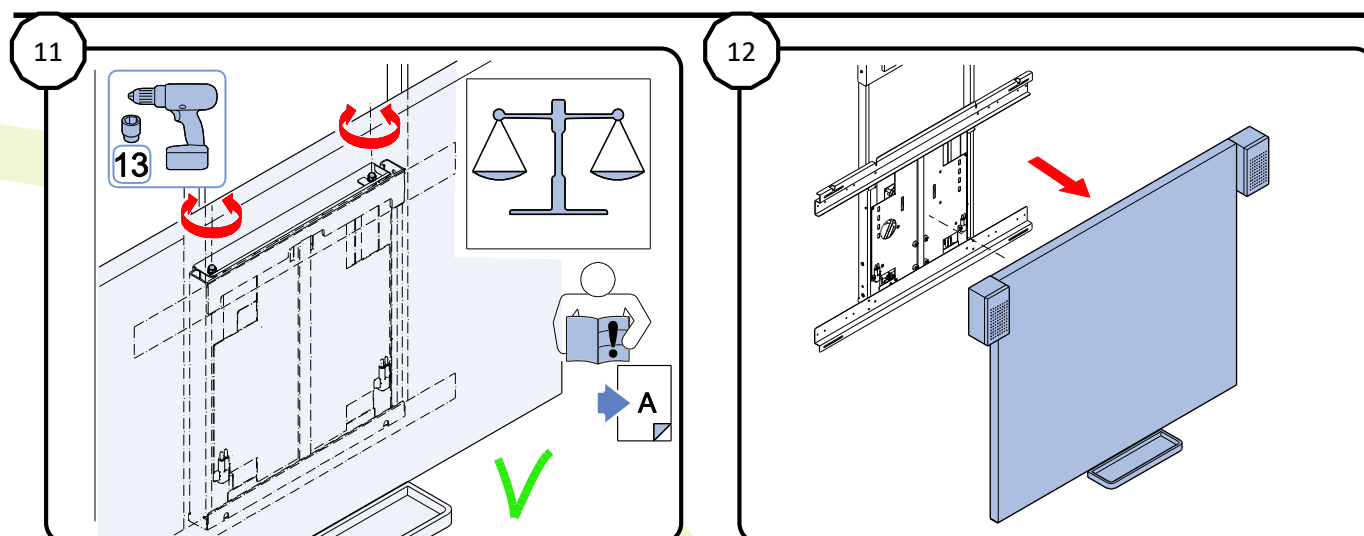

Adjust the BalanceBox springs to balance

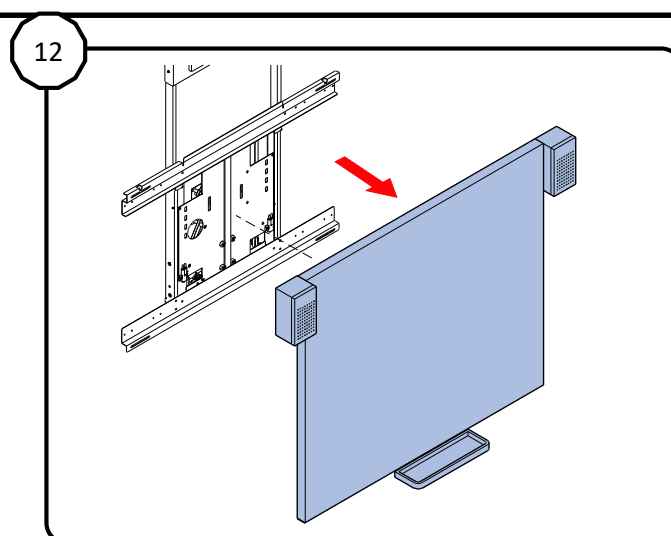

Take the board down from the hook

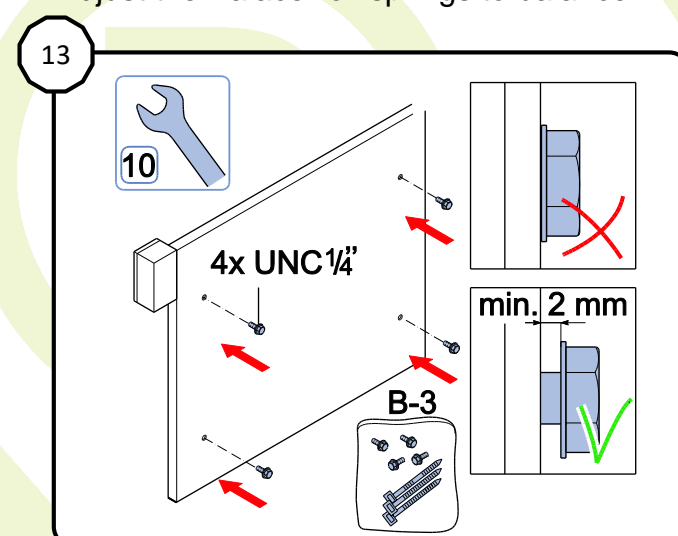

Mount 4 UNC bolts in the holes on the back of the board, do not tighten

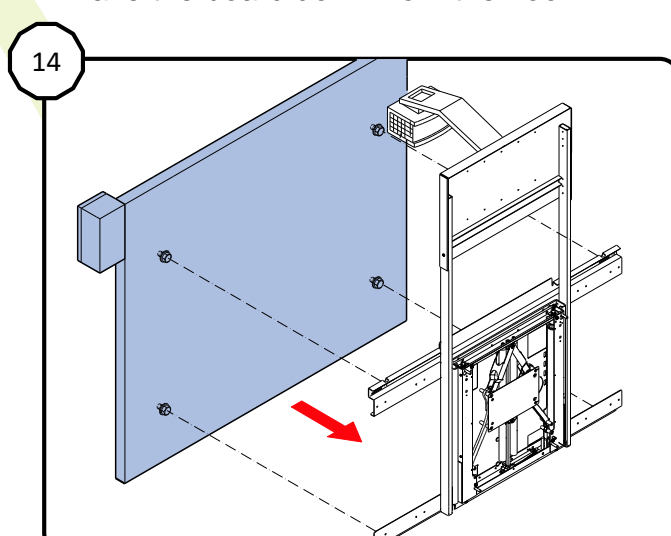

Mount the board in the mounting slots as shown

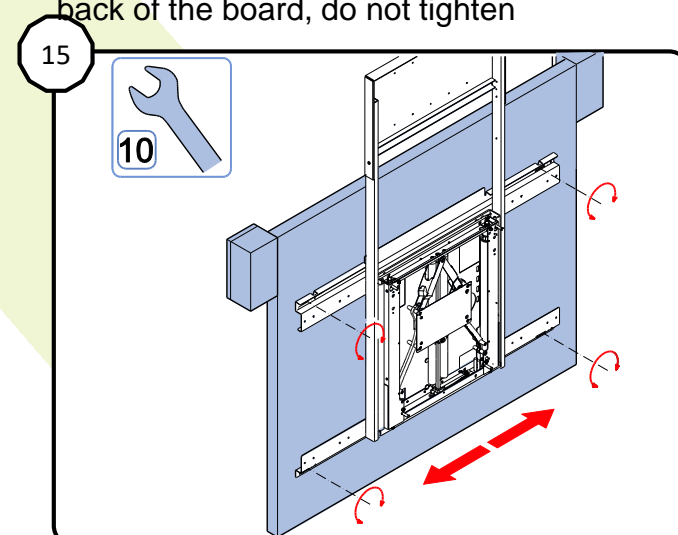

Adjust the position of the board left/right to match the projector image, tighten the UNC bolts

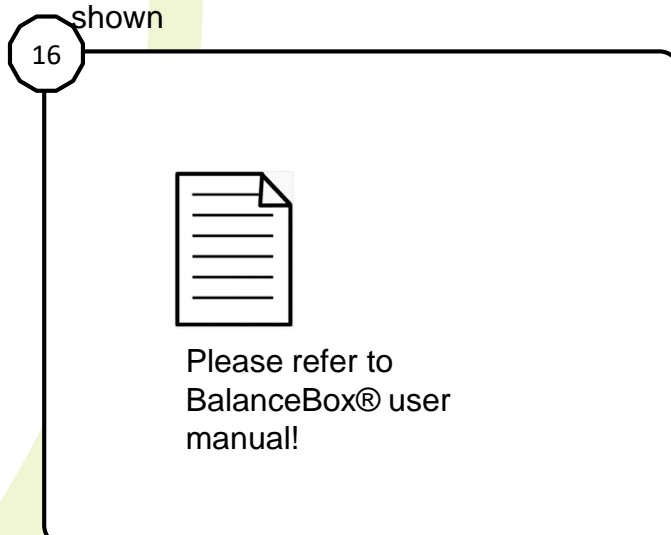

Please refer to
BalanceBox® user
manual!

BalanceBox®
HEIGHT ADJUSTABLE MOUNTS

SMART™ whiteboard frame for the BalanceBox® 400H Installation manual

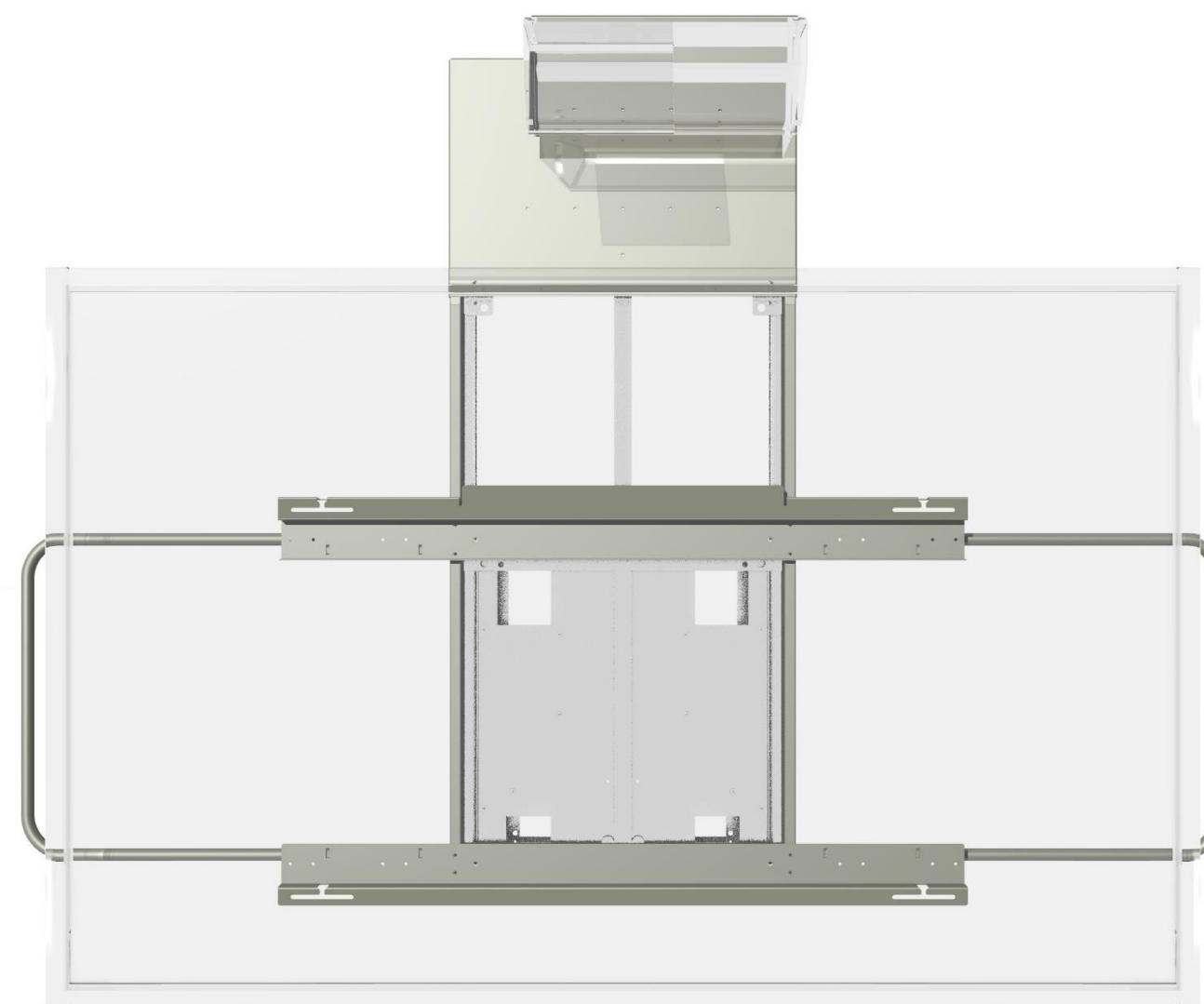

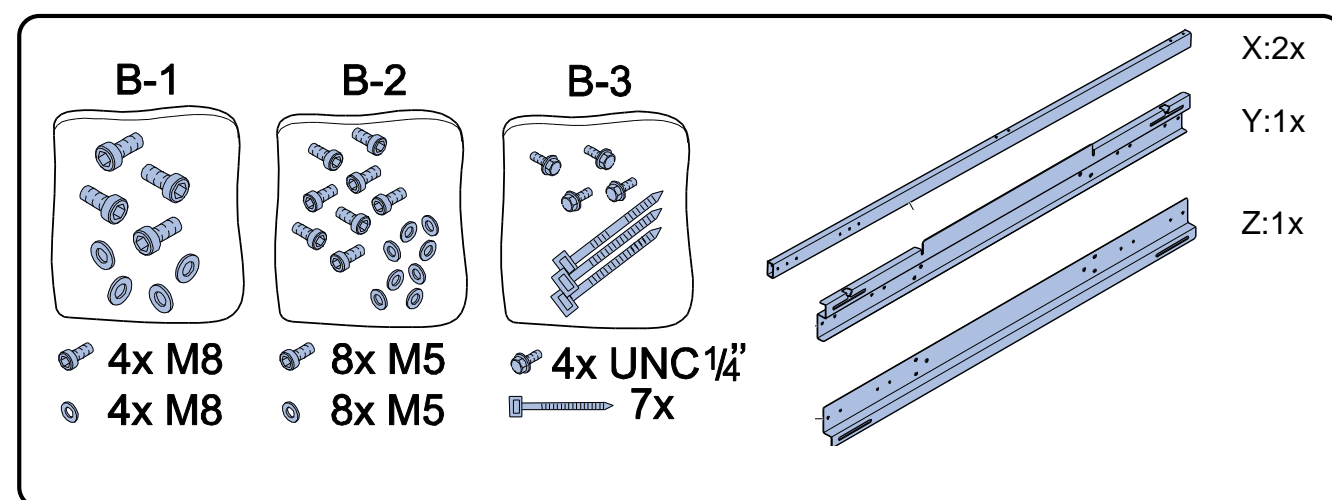

Contents of the box

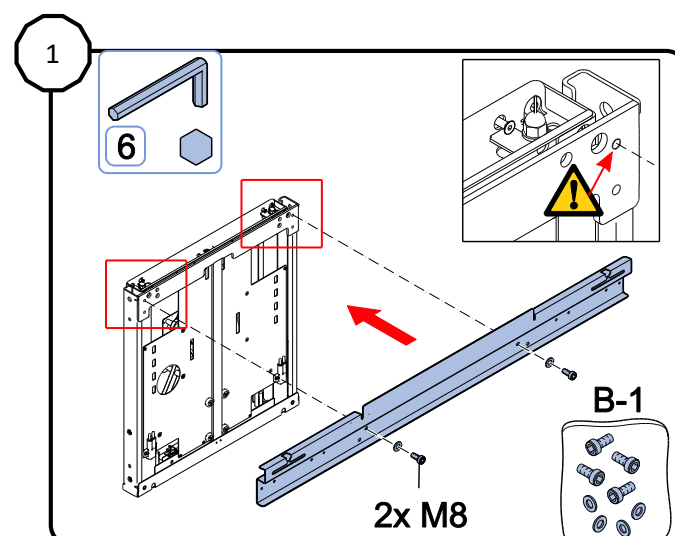

Assemble part Y

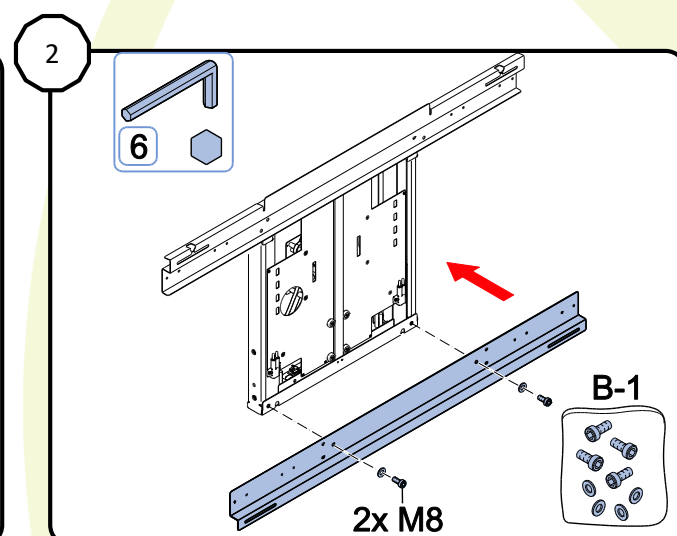

Assemble part Z

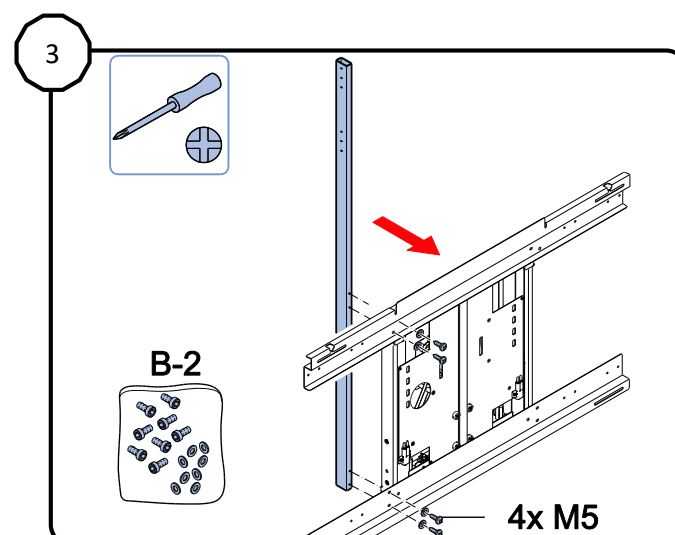

Assemble first tube X

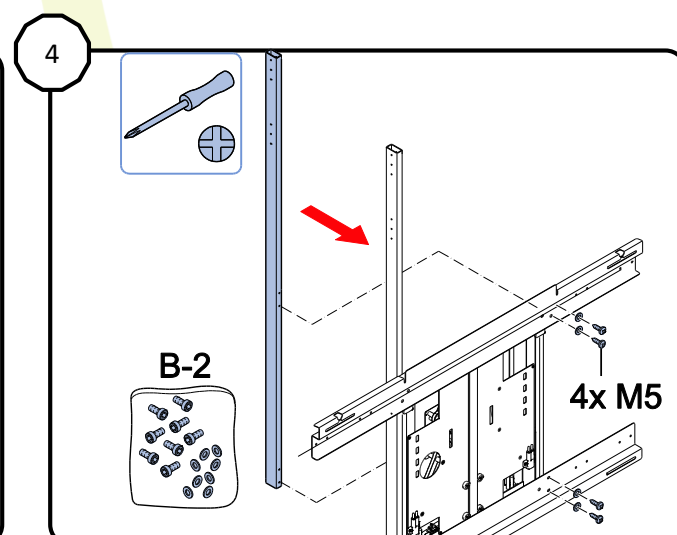

Assemble second tube X

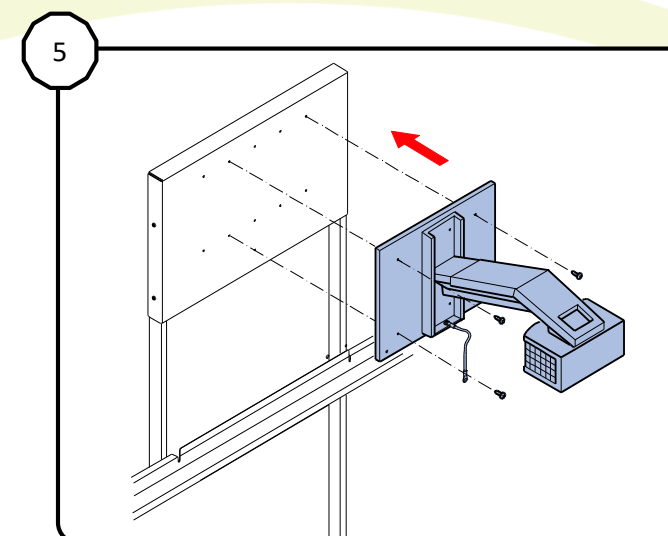

Mount projector plate and projector (not included)

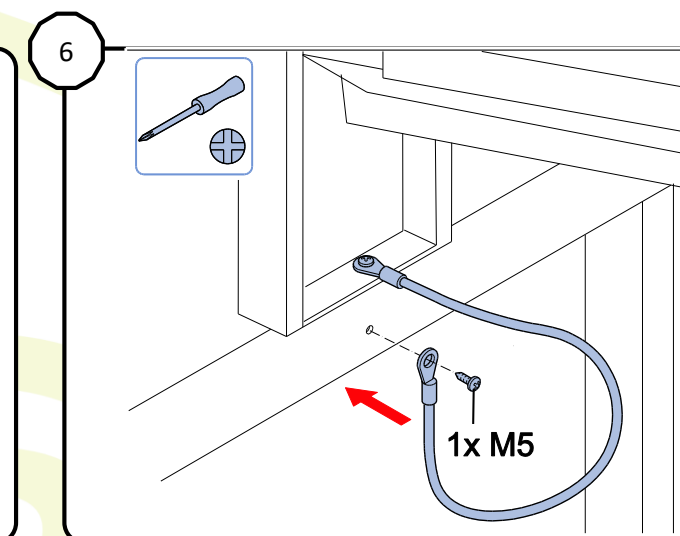

Install wiring (not included)

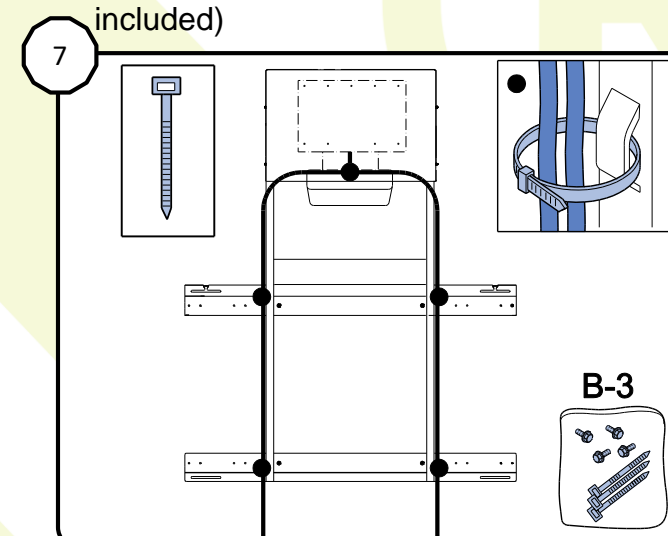

Fix wiring using tyraaps

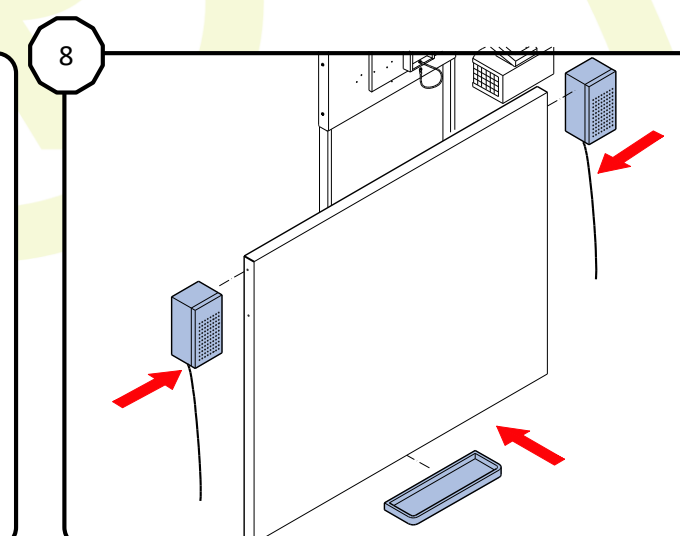

Mount speakers and accessories (not included)

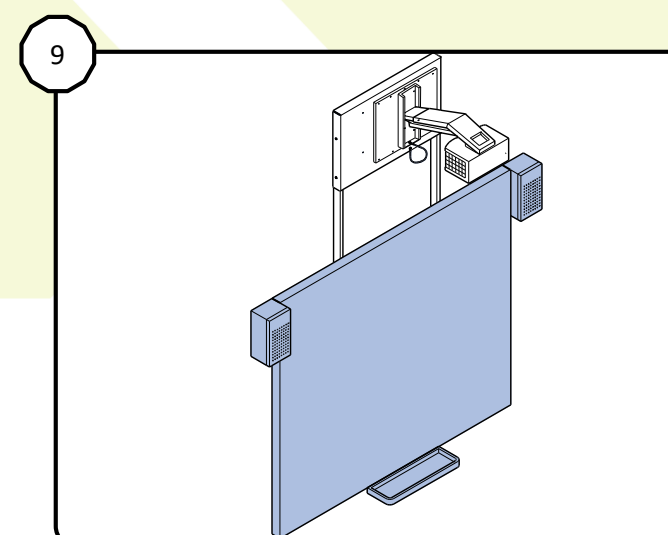

Mount SMARTboard™ for spring adjustment

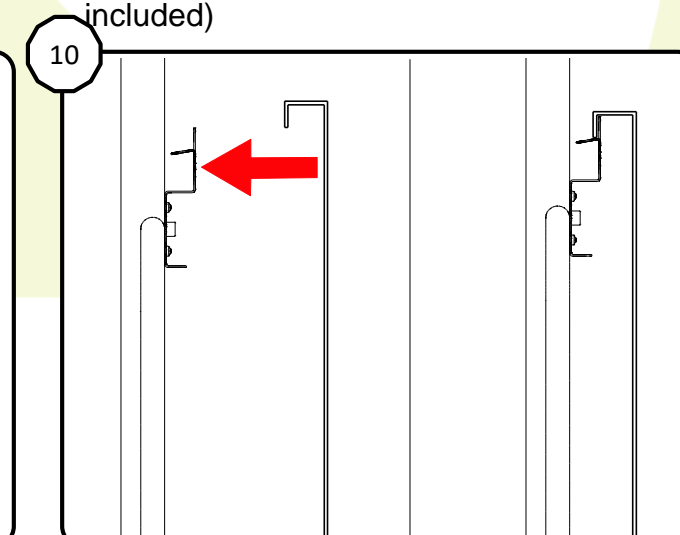

Hang top of board on hook for spring adjustment